



User Manual





Congratulations on your purchase of the Slubb Masturbator. This unique tool was designed for your pleasure by two German kinksters.

To get the most out of the device, make sure to follow the instructions, use lube and, avoid using the device over irritated skin.

You will come to understand why Professional Dominatrix's and Dom's prefer this masturbation tool over any other.

The Slubb is a vibration tool with our trademarked and patent pending attachment that offers even the most "reluctant" person access to orgasmic pleasure.

Quick Start

- Fully charge the battery pack until there are 3 green LED's (see instructions)
- Attach the Slubb Attachment (see instructions)
- Adjust the Slubb attachment so that it loosely fits over the penis
- Lubricate the penis with a silicone based lube (condoms are recommended for initial play)
- Begin with the lowest level of vibration
- Slowly move the Slubb up and down over the penis
- Adjust the setting to make the experience fantastic
- When done, remove the Slubb attachment
- Clean the Slubb attachment as instructed
- Store the Slubb and the machine in dry location out of direct heat or sunlight.

Please proceed with caution. Read the instruction manual and follow the guidance so that you can enjoy safe, sane and consensual play.

Enjoy the Slubb!!

Slubb USA

slubbusa@gmail.com

Operation Manual

Table of Contents

I. SAFETY PRECAUTIONS.	4
General safety instructions for power tools	
Safety instructions for battery chargers and rechargeable batteries	
II. TECHNICAL INFORMATION.	5
scope of delivery	
part designation	
Technical data cordless multifunction tool 002- 2021 SM	
Specifications for charger 002-2021 SM	
Technical data for battery 002-2021 SM	
Noise Emission Values	
Intended Use	
III. BEFORE START-UP	8th
Attaching and removing the battery	
charge indicator	
IV. ASSEMBLY	9
Mounting the attachment	
V. SLUBB ATTACHMENT	10
Power on/off	
select speed	
VI. USE	11
VII. WORKING INSTRUCTIONS	12
maintenance	
Lubricate	
cleaning	
recycling	
VIII. DECLARATION / CERTIFICATES	14
IX. CONTACT. . . .	

I. SAFETY PRECAUTIONS

Please read the user manual carefully before using it for the first time.

Failure to comply with the safety instructions can cause electric shock, fire and/or serious injury. Keep all safety warnings and instructions in a safe place.

General safety instructions for power tools

Keep your work area clean and well lit. Clutter and unlit work areas can lead to accidents. It's best to keep your work area free of all clutter.

Do not use the power tool in a potentially explosive environment in the presence of flammable liquids, gases or dust. Fumes can ignite, and power tools sometimes create sparks. Keep children and other people away from the work area while using the power tool. When distracted it is easy to lose control.

Keep power tools away from rain or moisture. Water getting into the power tool increases the risk of an electrical hazard including shock.

Pay attention, watch what you're doing, and work with the power tool exercising caution.

There are times to avoid working with a power tool. Do NOT use power tools when you are tired or under the influence of drugs, alcohol or medication. A moment of carelessness while using the power tool can result in serious injuries.

Avoid unintentional start-up. Verify that the power tool is switched off before connecting it to the power supply and/or the battery. Do not keep your finger on the switch when carrying the power tool, or the power tool may turn on unexpectedly.

Safety instructions for battery chargers and rechargeable batteries

This product is not intended to be used by children or by people with physical disabilities, sensory limitations or mental challenges, or by persons with lack of knowledge or experience handling tools like this.

The power tool is not a toy. Do not allow children to play with this potentially dangerous power tool.

Only charge the battery with the charger included in the package.

Charging with another charger can damage or even destroy the battery!

Incorrect handling can cause the battery to overheat enough to create a fire hazard.

Before charging the battery, make sure that the battery, all connecting cables and the charger itself are undamaged.

Do not attempt to charge a damaged battery or use a damaged charger!

The device and the batteries should only be used in a clean dry space. Protect the device and the battery from excessive heat by keeping them away from heaters and out of direct sunlight, failure to do so increases the risk of unexpected explosion.

Do not use non-rechargeable batteries with this device.

Make sure the device is turned off before inserting the battery. Inserting a battery into a power tool that is turned on can lead to severe accidents.

Do not dispose of used and defective batteries in household garbage

When it's time to dispose of the battery, please bring it to your garbage transfer center or collection point.

II. TECHNICAL INFORMATION

Table of Contents

- Operating manual
- Multifunction tool
- Battery pack
- Rapid charger
- Allen key
- Power adapter

Parts Enclosed

Power pack with battery and charger (picture)



Machine body with battery



Technical data cordless multifunction tool 002- 2021 SM

Battery voltage 12 V

Idle speed 5000-19000 rpm

Oscillating angle 3.0 degrees

Specifications for charger 002-2021 SM

Input 100-240V 50-60Hz 27W

Output 13.5V 1.5A

Charging time approx. 1 hour

Technical data for battery 002-2021 SM

Rated voltage 12V

Capacity 1.5A

Battery type Li-ion

Noise Emission Values

Sound pressure level LpA 76 dB(A)

Sound power level LWA 87 dB(A)

Uncertainty K 3 dB(A)

Hand-arm vibration aw ah:3.56 m/s²

INTENDED USE

The power tool's intended use is to saw and cut wood, plastic, plaster, non-ferrous metals, and fasteners such as nails and staples.

It is suitable for cutting wall tiles, as well as dry sanding and scraping small areas. The machine will work as intended when used appropriately. Any other use is not intended or recommended.

Use the device at your own risk. The user/operator is liable for any damage or injury caused. Unsafe use is not the responsibility of the manufacturer.

Please note that our devices are not intended for commercial use, heavy labor, or industrial use.

We do not warrant the tool if used in commercial settings, industrial settings or equivalent operations.

The manufacturer recommends that for general use, the tool should be kept at the level and used on the lowest speed setting to do the job. The user should wear appropriate protective equipment and use the machine with caution attending to the safety of the eyes, and hands on or around the tool.

Please note that when using a power tool, even if you take all the precautions recommended, there is always a risk of injury.

III. BEFORE ASSEMBLY

The battery is shipped with a partial pre-charge. Before using the machine for the first time you will need to charge the battery fully.

Attaching and removing the battery

Insert the battery into the handle until it locks in place.

To remove the battery, press the two battery-pack latches simultaneously and pull the battery out of the handle.

Insert the battery into the charging cradle.

Note the polarity markings on the battery and charging cradle.

Plug the charger into a grounded main socket. The red charge indicator light will turn on during charging.

The charger and the battery get warm during the charging operation and there may be a slight hum, this is normal and does not indicate a fault.

The charging process can take up to a maximum of one hour. The green charging light will turn on when battery is fully charged.

Unplug the charger from the power outlet after charging is complete.

To protect against electric shock, injury and fire hazard refer to safety instructions for battery chargers and rechargeable batteries.

Important instructions

When the battery is charged for the first time or after a long period of storage, it only reaches 80% of its nominal capacity. The battery only develops its full charge after several charging and discharging cycles.

Charge the battery only at an ambient temperature between plus 40°F and plus 86°F and allow it to cool to room temperature both before you charge it as well as after it has been charged before using it.

Charge Indicator

To manage your work, the battery is equipped with a 3-level charge indicator.

- Three green LEDs means battery fully charged
- Two green LEDs means battery is 50% charged
- A single green LED means time to charge the battery

IV. ASSEMBLY

Mounting the attachment

Open the flange screw with the provided hex wrench and remove the outer flange.

Place the attachment on the inner flange. The attachment can be attached in 12 different positions. It is thus

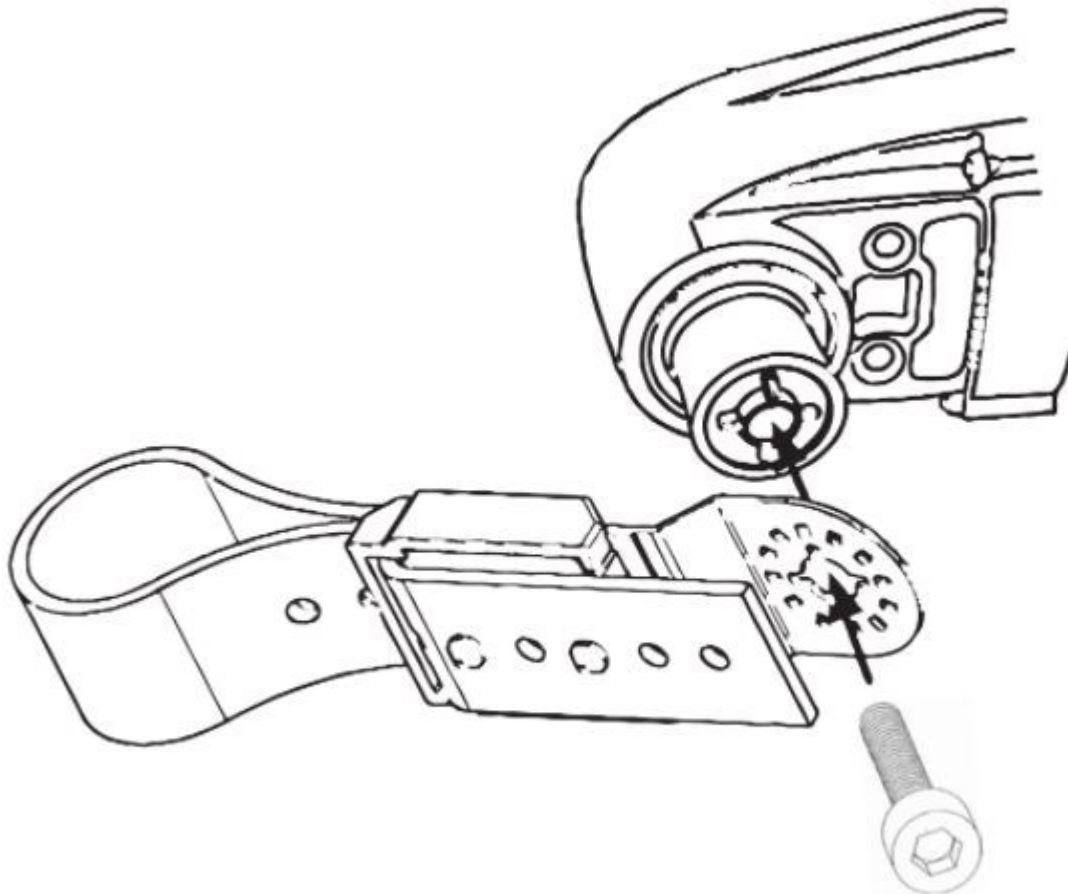

V. SLUBB ADJUSTMENT

To prepare your Slubb, insert the strap sliding through the guide so it makes a loop. Push the strap far enough through the guide to allow the loop to reach the desired diameter.

Before securing the strap, make sure that the loop is not too tight around the penis, the desired effect is best achieved with a light touch. Allow the space the size of a finger before you secure the end of the strap with the holes on the clamp heads. We cannot emphasize this enough. The strap should not be tight around the penis.

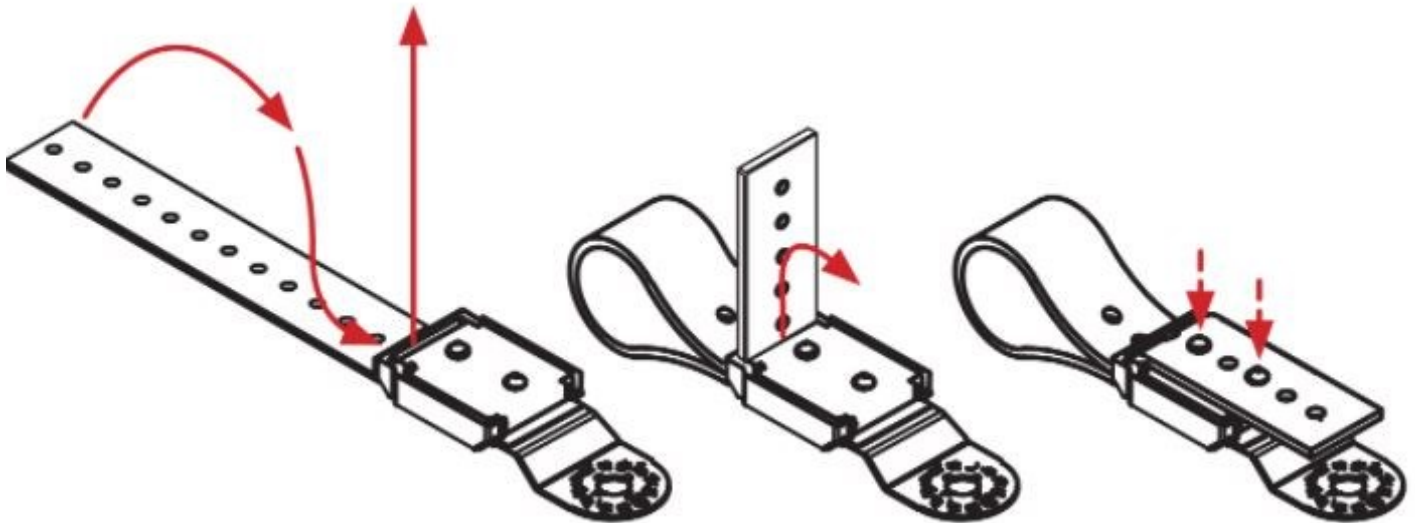

Power on/off

The on/off switch is located on the top of the device.

Power on: Slide the switch forward to position 1

Switch off: Slide the switch back to position 0

Speed Selection

The speed is variable and can be controlled using the speed controller. You can vary the speed in a Range between 5,000 rpm. and 19,000 rpm.

To adjust the speed, the controller is marked with six levels starting with >1< for the minimum speed and ending at >6< for the maximum speed.

VI. USE

IMPORTANT. Lubrication is required for safe use.

To guarantee optimal pleasure, use the Slubb masturbator with a silicone-based lubricant, and add as needed. DO NOT use mineral oils or fats as lubricant to avoid damaging the belt!

The use of lubricant protects your skin and the rubber straps.

Please do NOT use the Slubb on irritated body parts or over irritated skin.

We recommend using a condom as an extra protection against abrasion to begin with.

Getting Started

To get started, take the previously adjusted loop and lower it over the lubricated penis.

Adjust the strap so that it is a loose fit around the penis.

Turn the machine on at the lowest vibration level as previously described.

Move the Slubb Masturbator evenly and slowly from the tip of the glans down over the shaft toward the trunk and back again.

If you find a location on the penis that is particularly stimulating pause there for a moment before moving the Slubb along.

Continue till satisfied.

VII. MAINTAINANCE INSTRUCTIONS

Maintenance

Keep the connector contacts on the charger and battery clean. Do not attempt to replace internal components.

Lubrication

Your power tool does NOT require additional lubrication.

Cleaning

Clean the charger body with a soft, dry cloth. Before doing so, unplug the charger from the outlet

Remove the battery before cleaning the charger or the battery. Make sure the

Ventilation slots remain open and free of dust accumulation. Clean the housing of the machine regularly with a soft cloth.

Clean the Slubb masturbator before and after every vibration session with a standard toy cleaner. Spray the toy cleaner on the rubber strap and let it soak briefly. Then wipe dry with a clean cloth.

Please ensure that no liquid gets into the plastic housing!

Once the Slubb masturbator is cleaned and dry, you can safely store it for future.

Recycling

Most batteries meet the definition of dangerous waste, but when they are properly recycled, they are minimally regulated.

Mercury, lead, cadmium, and sulfuric acid can leak from batteries and pose environmental risks when they are improperly stored or disposed of. Specific rules apply for this battery.

The universal waste rule can apply to all batteries that are dangerous waste. Homeowners are not required to manage their batteries as universal waste but are strongly encouraged to take them to a household hazardous waste collection facility instead of throwing them away. This product must be disposed of at a designated collection point. Improper handling of old devices can lead to potentially hazardous substances that are often produced when electrical and electronic equipment is improperly disposed of.

Waste electronic equipment contributes to environmental damage as well. By disposing of this product properly, you also contribute to the effort to protect the environment. You will find information on collection points of electronic devices at your city administration, the public waste disposal authority or the garbage disposal authority. Also, please dispose of the product packaging in an environmentally friendly manner.

Do not dispose of used batteries with normal household waste, please hand them in at the designated collection points (specialist shops, recycling depot).

VIII. DECLARATION / CERTIFICATES

This product, model M9194T with article number 002-2021 SM, complies the requirements of the applicable European and national directives 2006/42/EC of the Machinery Directive and EMV 2004/108/EC.

The full text of the declaration of conformity can be requested at info@slubb.store. Technical documentation available at Slubb.Store, Friedhofstraße 10 in 42929 Wermelskirchen.

IX. CONTACT

Slubb.Store
Friedhofstrasse 10
42929 Wermelskirchen
Email: info@slubb.store
www.slubb.store

North America

Slubb-USA.com
Email: SlubbUSA@gmail.com